

Box Header With Ejectors 2.54mm(0.100")

GXCON

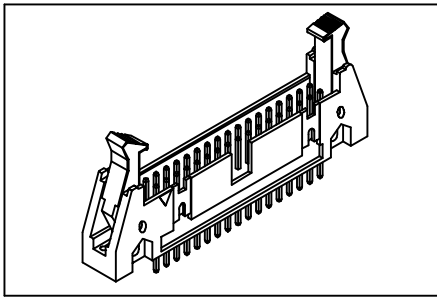

Material:

Housing: 30% Glass filled PBT UL94V-0.

Contacts: Brass.

Plating: Gold plated over nickel.

Tin plated over nickel.

Selective gold plated: Gold Plated on mating area and tin plated on solder tail.

Electrical Characteristics:

Current Rating: 1 AMP.

Insulator Resistance: 5000MΩmin. at DC 500V.

Contact Resistance: 20mΩmax. at DC 100mA.

Operating Temperature: -55°C~+105°C.

Features:

- * Choices of Eject lever.
- * Fully shrouded provides ultimate reliability.
- * Black or gray insulator available.

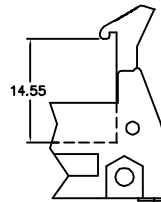
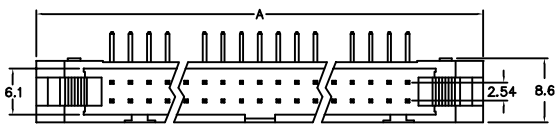

Long Lever

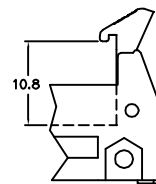

Short Lever

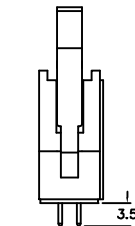
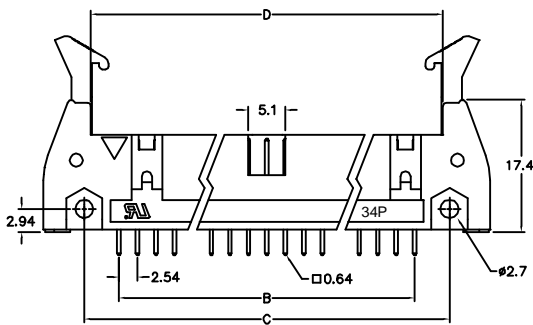

Straight Type

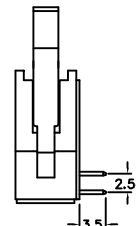

Right Angle Type

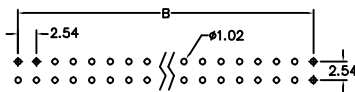

P.C. Board Layout

Position	Dimension			
	A	B	C	D
10	31.88	10.16	21.84	17.96
14	37.02	15.24	26.92	23.04
16	39.52	17.78	29.46	25.58
20	44.74	22.86	34.54	30.66
26	52.20	30.48	42.16	38.28
34	62.40	40.64	52.32	48.44
40	70.04	48.26	59.94	56.80
50	82.72	60.96	72.64	68.76
60	95.40	73.66	85.34	81.46
64	100.50	78.74	90.42	86.54

Ordering information

BX01- 64 1 1 B 1
 Series No. of Pin Count 1: Gold Plated 2: Tin Plated 3: Selective Gold
 1: Straight 2: Right Angle
 B: Black Y: Grey
 1: With Long Ejectors 2: With Short Ejectors 3: Without Ejectors